



First Brand of Household Central Audio
Third Generation Household Intelligent Audio Leading Products



Room Controller

USER MANUAL BM828RII



Address: No.1 Xiahe Rd, Jianggao, Baiyun, Guangzhou, China
Post Code: 510450
Tel: +86-20-28340886
Website: www.dsppatech.com

Australia AUCO Video Technology Co., Ltd.
Guangzhou Auxdio Audio Co., Ltd.

Contents

Characteristics of Product	1
Description of Functions	2
Setting of System	5
Dimension of Product	7
Performance Parameters	7
Installation and Wiring	8
Packing List	11
Precautions for Warranty	12

Characteristics of Product

- Convenient and efficient home music control center.
- 3.5" TFT LCD display screen, fully touchable operation.
- Luxurious appearance design, optional colors in black and white.
- With the operational functions of the AM8318, AM8328, and AM8328II hosts, including selection of sound sources and playing control of sound sources.
- One BM828RII controls one partition by means of setting of address.
- Control external DVD and TV through the infrared learning function of the host.
- Subject to the control and operation by the infrared remote controller.
- Controllable distance up to 100 meters.

Typical Applications:

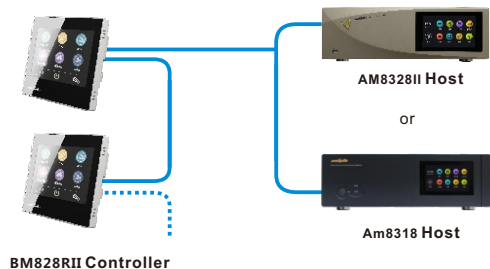

Description of Functions

Introduction to Main Interface

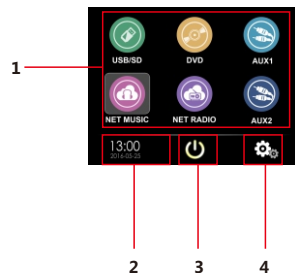

- 1.Area for selection of the sound source.
- 2.Time and date.
- 3.Switch.
- 4.Setting.

Description of USB/SD Playing

Touch the "USB/SD" sound source button on the main interface, and the framing of the button in the frame indicates the selection. Then, touch such button to enter the USB/SD playing control interface, so as to implement the remote control of the USB/SD player of the host, as shown in the figure below:

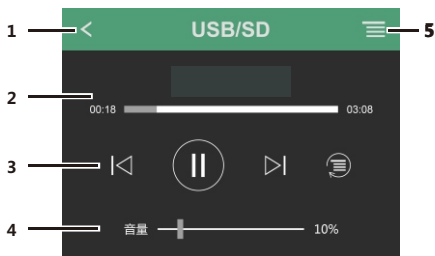

- 1.Back button (Back to the main menu);
- 2.Information on playing (Displaying name of song and the progress of playing);
- 3.Playing control area (Including previous song, play and pause, next song, and operation of the playing mode);
- 4.Volume control area (Adjusting the volume);
- 5.Playing list (Entering the playing list edition page).

Description of external sound source playing

- ① The external sound sources include **DVD, AUX, Internet music, Internet radio**, and Internet video on demand. For DVD and other sound sources, the same control mode for playing is adopted. Here, the playing control of DVD is used as the example for description. Please refer to the instructions to DVD for the control operations of the other external sources. Among all the external sound sources, except for the DVD and AUX which can not be controlled unless the infrared learning is conducted on the host, the infrared learning is not needed for the other external sound sources (Please refer to the operation instructions to the host used by you for how to conduct the infrared learning).
- ② On the main interface, touch the "DVD" sound source button to enter the "DVD" playing control interface as shown in the figure below:

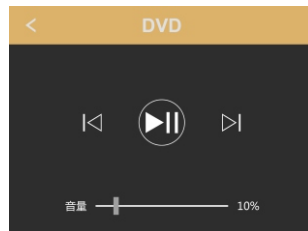

- ③ By the infrared learning on the host, it is possible to learn the functions of DVD such as selecting songs forward and backward and play/pause. After completing the learning, it is possible to use such functions directly on the remote controller. It is possible to complete the volume control of all the sound sources directly without learning.

Setting of System

Touch the “set” button on the main interface to enter the operation interface of system setting. On such interface, it is possible to set the room under the control of this equipment, language, lighting time of screen background light, and setting of the bass and treble.

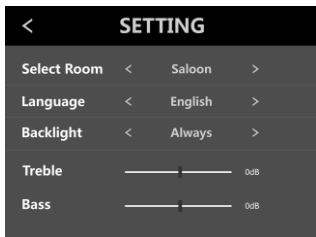

● Selection of room

! You should turn on the “terminal address setting switch” on the host (Please see the operation instructions to the host used by you).

On the system setting interface as shown in the figure above, touch the triangle symbol button at left and right side of the item “selection of room” to change the room you intend to control with such equipment.

● Selection of language

Touch the language following the “selection of language” gently, in order to switch over the language of the system between Chinese and English.

● Setting of backlight

Touch the time following the “setting of backlight” gently, to switch over the backlight time of the controller among “10S”, “30S”, “60S”, and “normally on”.

● Setting of bass and treble

Slide the bass setting slider left or right to adjust the output gain of the bass; slide the treble setting slider left or right to adjust the output gain of the treble.

Dimension of Product

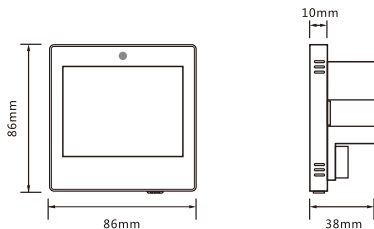

Performance Parameters

Item	Indicators
Connection mode	RJ45 cable connection
Infrared remote control	Supported
Distance of communication	100m
Control function	Selection of sound source, volume, room switch, controlling the playing of USB/SD and DVD connected to the host
Power input	9-30V DC
Dimension of product	86 x 86 x 38mm
Weight of product	214g

Installation and Wiring

- ① On the wall for installation, the groove suitable for the size of the cassette shall be cut out, and the holes shall be drilled out in the cassette on the wall according to the positions of the screws at the four corners at the bottom of the cassette, and the cable in the groove shall be prepared.

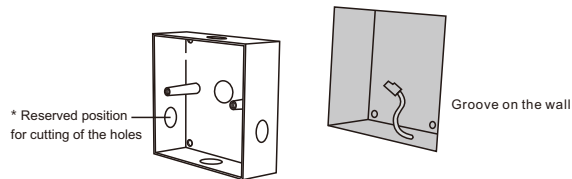

- * The circular positions for cutting of the holes shall be reserved at the bottom and the periphery of the cassette of the product, so as to enable you to select the proper holes for routing easily.

- ② Thread the cables through the holes reserved at the periphery of the cassette to place the cassette into the groove on the wall, and fix the cassette firmly in the groove on the wall with four expansion screws. .

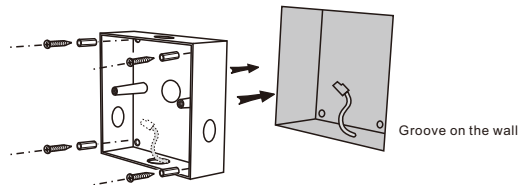

- ③ Connect the cable with the Internet access on the base of the controller, and then fix the base on the two erection columns of the cassette with two screws.

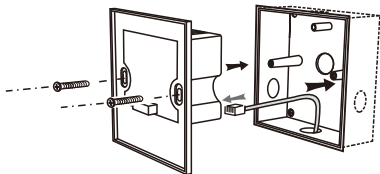

- ④ Fasten the panel of the controller onto the base mounted on the wall, and check whether the panel is fully clasped to the base.

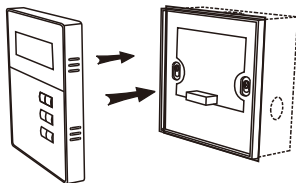

- !** There are two network interfaces on the back of the controller. If you purchased more BM828R111 equipments, the second network interface may be used for mutual connection; in such case, only one BM828R111 equipment shall be connected to the host, and the other BM828R111 equipments may be connected to the host.

Definitions of Internet Access Pins

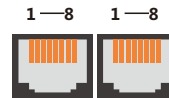

1. A
2. B
3. N/C (Null pin)
4. N/C (Null pin)
5. GND (-)
6. GND (-)
7. VDD (+)
8. VDD (+)

Manufacturing Method for Cable

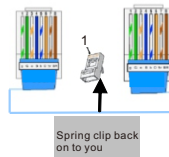

Rj45 interface

When connecting, the colors from the left side to the right side are: Green and white, green, orange and white, blue, blue and white, orange, brown and white, brown, which are corresponding one to one at both ends.

Prompt: The colors for wiring in the drawing are indicated only for illustration. The practical wiring shall be subject to the material objects.

Packing List

Component	Quantity
Controller Panel	1
Controller Base	1
Cassette	1
Installation Screw Package	1
Operation Instructions	1
Quality Certificate	1
Warranty Card	1

Precautions for Warranty

To: Respectful users

Thank you for your use of our products! We hope that you could create more values with our products! Please read the following instructions carefully and keep such operation instructions properly:

1.The term of the warranty shall be one year (counted from the date of sales); for the purpose of warranty, such operation instructions and the vouchers for purchase must be available.

2.The following shall not be deemed as falling within the scope of the free service:.

A.The out of the warranty.

B.The nonconformance of the product model and number on the operation instructions to the physical commodities.

C.The damage arising from the abnormal operation not according to the operation instructions to the product (Including the damage caused by the repair done by the repairer not undertaking the quality warranty).

D.The damage caused by the force majeure.

E.The alteration to the content of the warranty card without authorization.

F.The battery of the remote controller.

When using such equipment, please give full consideration to the occurrence of the special circumstances and take the protective measures in advance. Our company will not undertake the collateral loss arising from the damage to the product. Please contact the dealer directly for solving any problem in the product.